

Block diagram

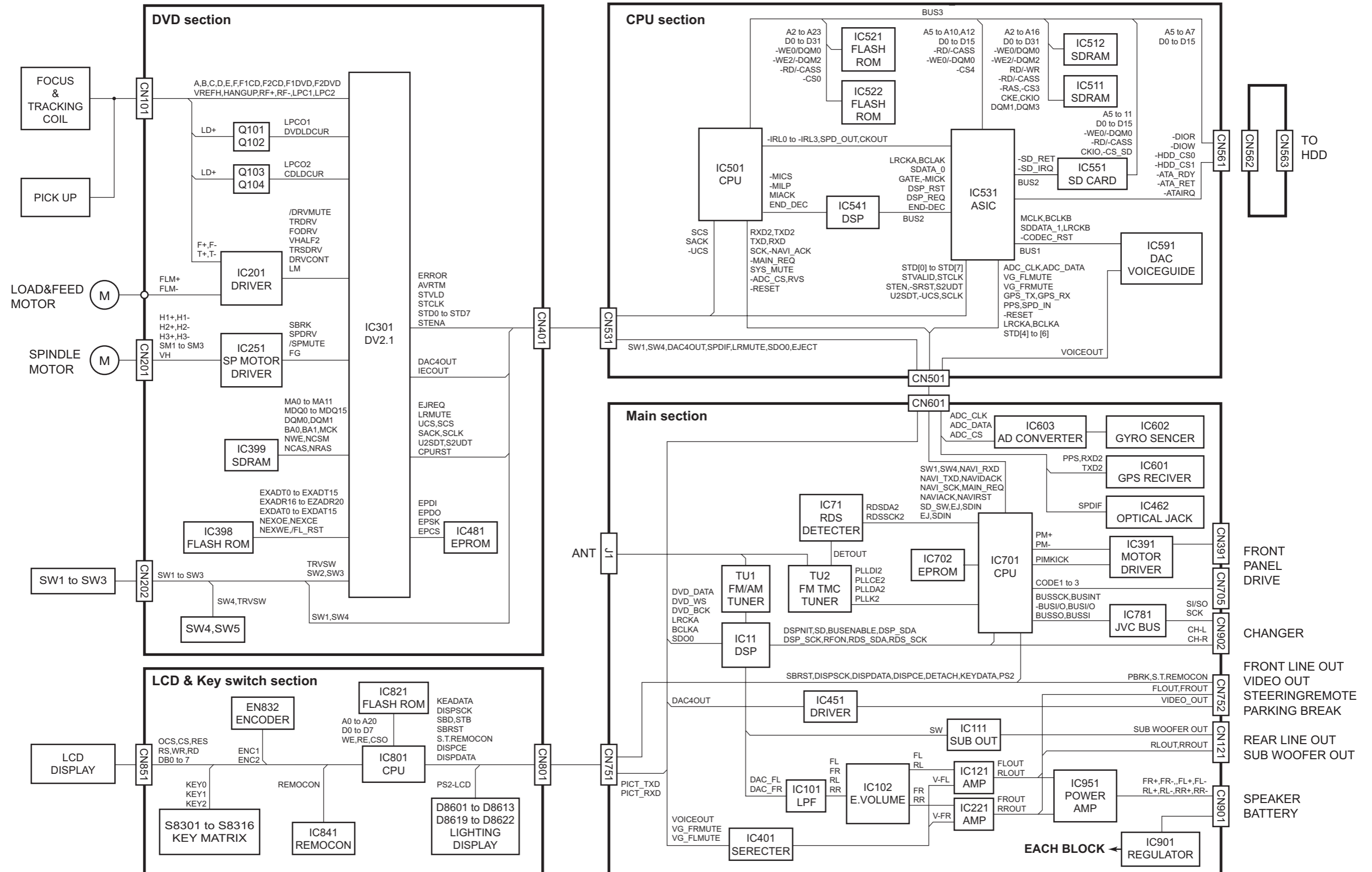

Standard schematic diagrams

■ Main section (1/2)

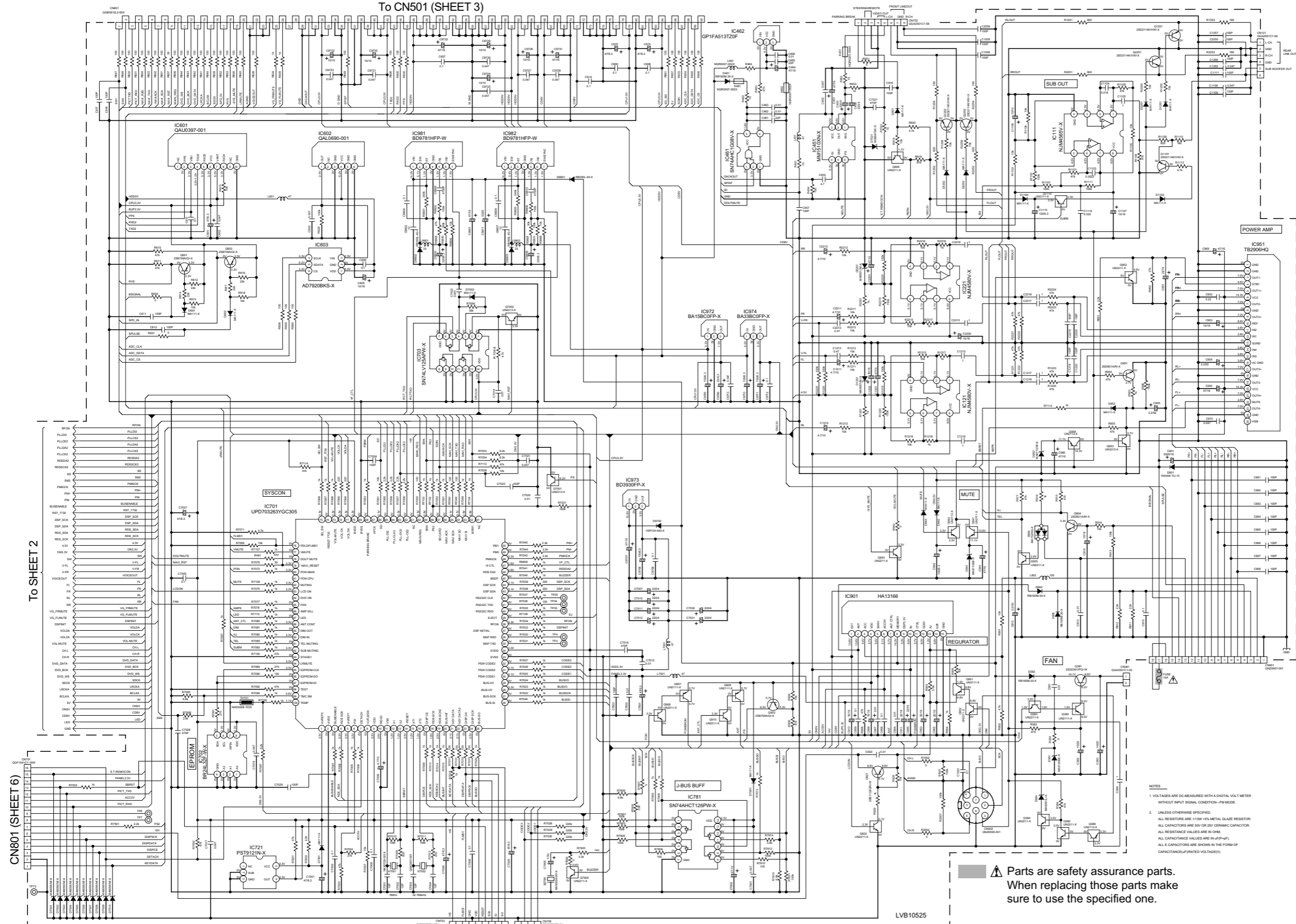

- NOTES
1. VOLTAGES ARE DC MEASURED WITH A DIGITAL VOLT METER WITHOUT INPUT SIGNAL CONDITION - FM MODE.
 2. UNLESS OTHERWISE SPECIFIED:
ALL RESISTORS ARE 1/10W 4% METAL GLAZE RESISTOR.
ALL CAPACITORS ARE 50V OR 25V CERAMIC CAPACITOR.
ALL RESISTANCE VALUES ARE IN OHM.
ALL CAPACITANCE VALUES ARE IN μF (P-PF).
ALL CAPACITORS ARE SHOWN IN THE FORM OF CAPACITANCE (RATED VOLTAGE).

⚠ Parts are safety assurance parts.
When replacing those parts make
sure to use the specified one.

■ Main section (1/2)

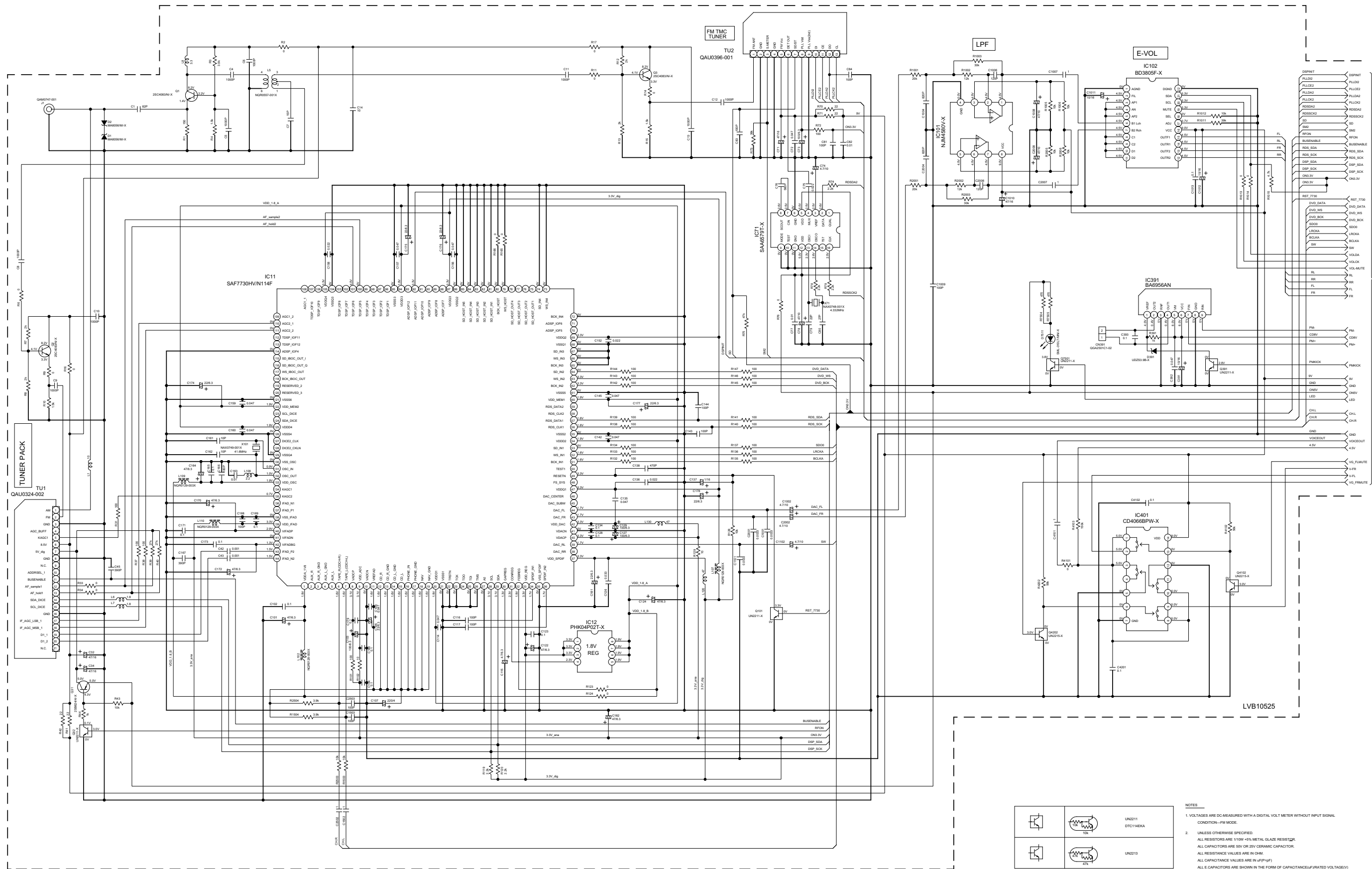

To SHEET 1

LVB10525

	UN2211 DTC114EKA
	UN2213

- NOTES
- VOLTAGES ARE DC-MEASURED WITH A DIGITAL VOLT METER WITHOUT INPUT SIGNAL. CONDITION—FM MODE.
 - UNLESS OTHERWISE SPECIFIED, ALL RESISTORS ARE 1/10W ±5% METAL GLAZE RESISTOR. ALL CAPACITORS ARE 50V OR 25V CERAMIC CAPACITOR. ALL RESISTANCE VALUES ARE IN OHM. ALL CAPACITANCE VALUES ARE IN pF(pF).
- ALL E-CAPACITORS ARE SHOWN IN THE FORM OF CAPACITANCE/(F)RATED VOLTAGE(V)

■ CPU section (1/2)

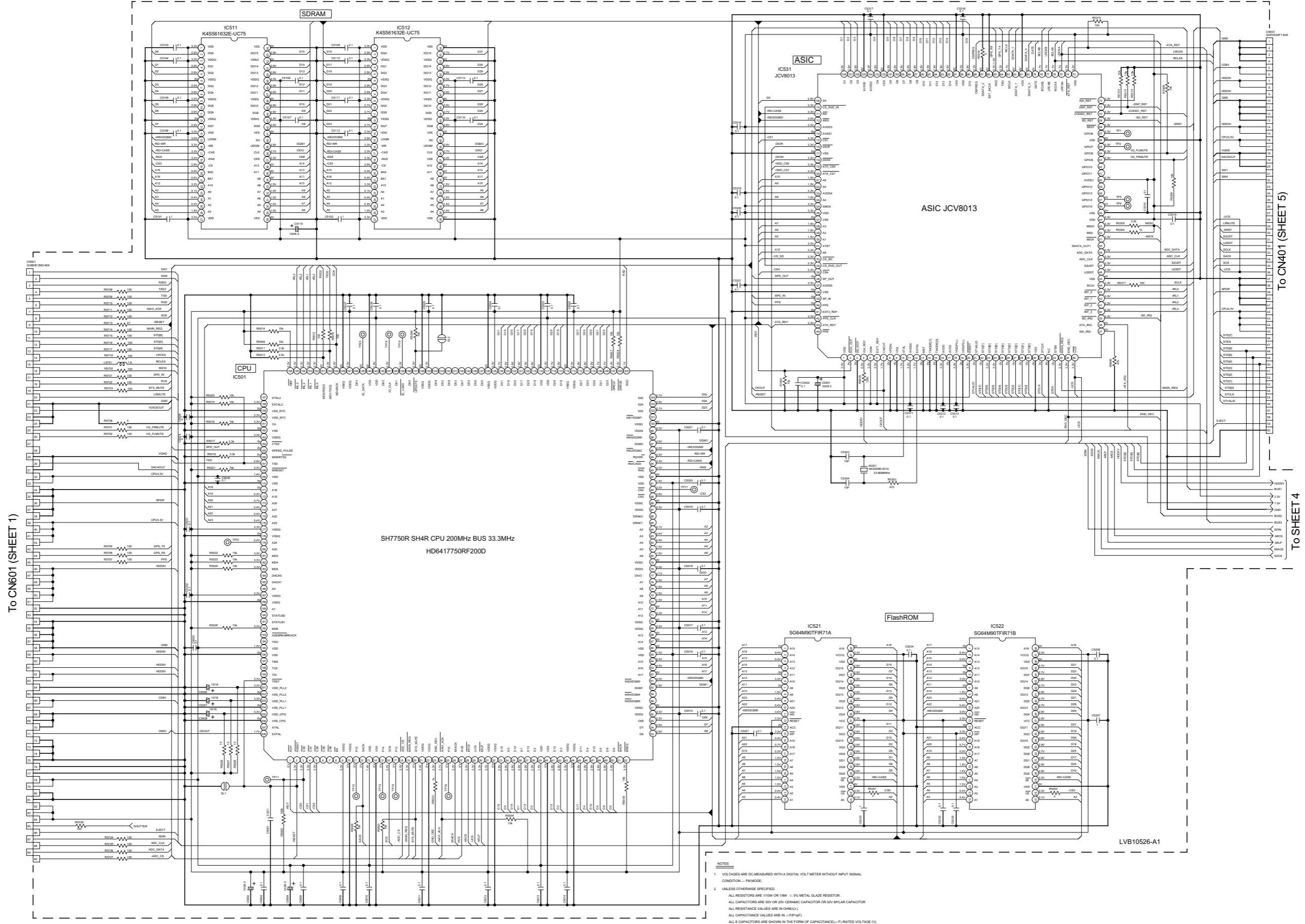

NOTES

- VOLTAGES ARE DC-MEASURED WITH A DIGITAL VOLT METER WITHOUT INPUT SIGNAL. CONDITION -- FM MODE.
- UNLESS OTHERWISE SPECIFIED:
ALL RESISTORS ARE 1/10W OR 1/8W ± 5% METAL GLAZE RESISTOR.
ALL CAPACITORS ARE 50V OR 25V CERAMIC CAPACITOR OR 50V MYLAR CAPACITOR.
ALL RESISTANCE VALUES ARE IN OHMS (Ω).
ALL CAPACITANCE VALUES ARE IN pF (pF).
ALL CAPACITORS ARE SHOWN IN THE FORM OF CAPACITANCE (pF) RATED VOLTAGE (V).

LCD & Key switch section

